

Master "Silent" Chain Cutting & Riveting Tool Set

This set main function for "Silent" chain type to repair used.
 All tool's parts by precision milled and CNC lathe construction.
 This set has good mechanism designed heavy duty & precision.
 Working for "Silent" chain as **Cutting, Replace, Link & Rivet.**
 Master figure to cutting & assembling the "Silent" Chain as well.
Noted: The pin must make sure to align the central of link pin in a vertical position no aslant.

Included of set:

- 1). "C" frame body with handle.
- 2-2.0). Cutting punch pin with thread in 2.0mm.
- 2-2.5). Cutting punch pin with thread in 2.5mm.
- 2-3.0). Cutting punch pin with thread in 3.0mm.
- 3). "T" pusher bolt driver.
- 4). Bored anvil bolt.
- 5). Alignment screw bolt.
- 6). Extractor pin 2 pieces in 2.5mm
- 7). Rivet tip.
- 8). Rivet anvil.
- 9). Impact rivet pin.
- 10). Flare Pin

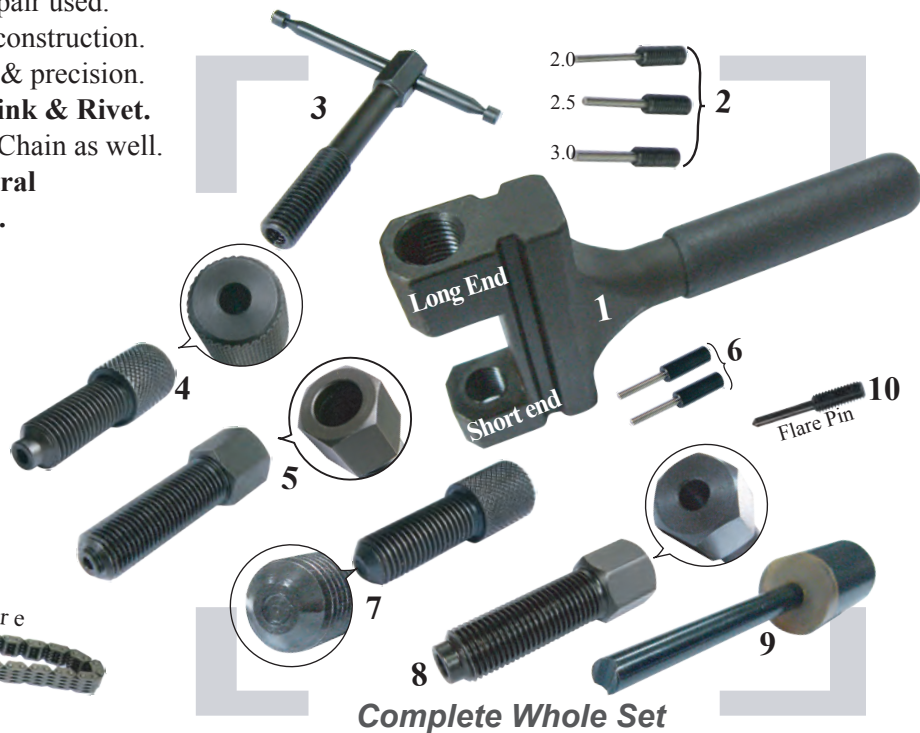

Operation Manual

Assembly for cutting link pin as removal:

- ① First stage: No.2 cutting punch pin into the No.3 "T" pusher bolt driver.
- ② Second stage: No.4 bored anvil into the No.1 "C" frame short end.
- ③ Third stage: No.5 alignment screw bolt into the No.1 frame long end.
- ④ Forth stage: No.4 anvil bolt + Chain + No.5 alignment bolt to fixed the chain.
- ⑤ Five stage: No.3 "T" pusher come with No.2 pins into the No.5 to drive forcedly the pin out.

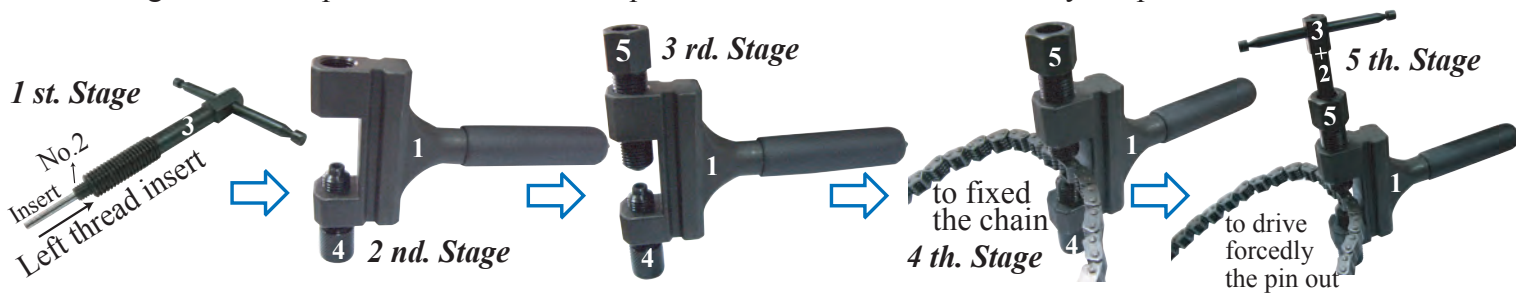

Assembly for replacement of the chain:

No.6 the two pins into the front end of the chain.



Assembly for rivet anvil (closed the chains):

- ① First stage: No.7 rivet tip into the No. 1 "C" short end
- ② Second stage: No.8 rivet anvil into the No.1 "C" long end for first pin to rivet.
- ③ Third stage: No.7 rivet tip into the No.1 short end + No.5 alignment bolt into the No.1 long end for chain become fixed.

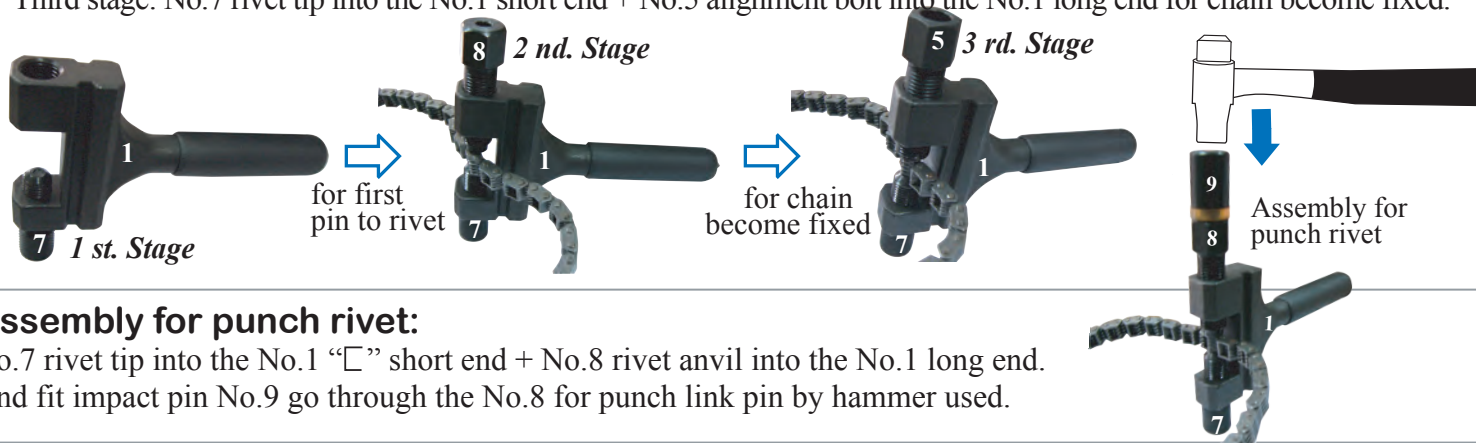

Assembly for punch rivet:

No.7 rivet tip into the No.1 "C" short end + No.8 rivet anvil into the No.1 long end.
 And fit impact pin No.9 go through the No.8 for punch link pin by hammer used.

No.10 Flare Pin Used