

SLA
FACTORY ACTIVATED

SLA | READY TO START

REF **6N6-3B/B-1****6v****VOLTAGE - V****50A****CCA - A****6.3Ah****CAPACITY - Ah (20Hr)****6Ah****CAPACITY - Ah (10Hr)****TECHNOLOGY**

- Designed according to AGM technology (Absorbed acid)
- VRLA battery type
- Activated and pre-charged batteries
- Homologated by OEM

FEATURES

- AGM construction (Absorbed Glass Material)
- VRLA battery (Valve Regulated Lead Acid)
- Factory activated
- Environmentally friendly, spillproof design
- Multi-positional fitment
- Absolutely Maintenance free
- Sealed, no gas emission through venting hole (under normal operation)
- Ready & Easy to use
- No acid handling - Very safe
- Increased power & Extended life
- Extreme vibration resistance

UPGRADE FOR**DRY 6N6-3B/B-1****WEIGHT**

Battery (with acid): Approx 1.16kg

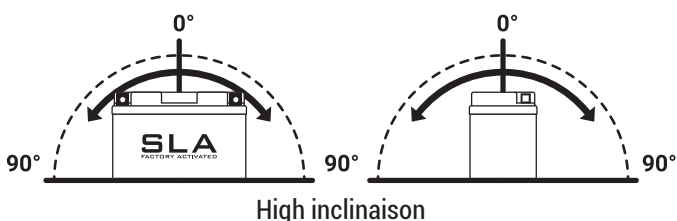
MOUNTING ANGLE**DIMENSIONS**

Length (A):	95mm ±2mm
Width (B):	55mm ±2mm
Container height:	117mm ±2mm
Total height (C):	117mm ±2mm

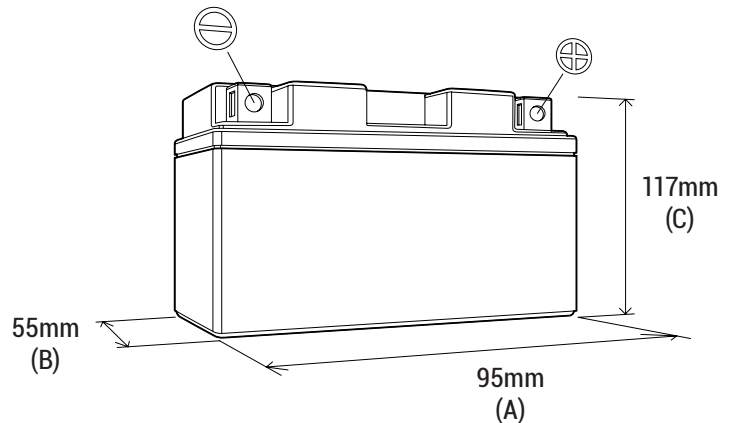
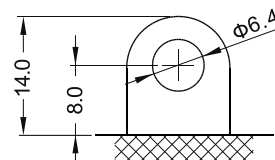
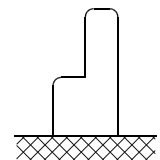
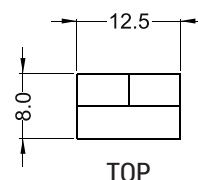
**TERMINALS (mm)****FRONT****SIDE****TOP**